



Go-Kart Chassis alignment instruction

These Instructions assume the kart is out of alignment and requires a full adjustment on camber, caster, toe and swing. Make sure to perform the procedure on a level stand.

1. Preparation

- (1) Remove both front wheels leaving only the applied spacer on and clean the axle thoroughly.



- (2) Straighten the steering wheel and lock in the center if possible.



2. Installing the laser

- (1) Turn the laser on and place it on the axle
- (2) Push the tool in against the spacer and check the direction on the top of the tool.



- (3) Check level bubble and level the tool.





3. Reading the current alignment.

- (1) Check on Both sides and ensure there is a projected laser dot. (The projected dot may exceed the grid if the toe is off by too much)



The setting shown shows *Toe* out and positive *Camber*. Now we can proceed to change the *Camber* and *Toe* out for either a new setting or to bring both sides of the cart to the same amount of *Toe* and *Camber*.

4. Adjusting Toe in/out

- (1) Loosen the Nut on the connecting rod.

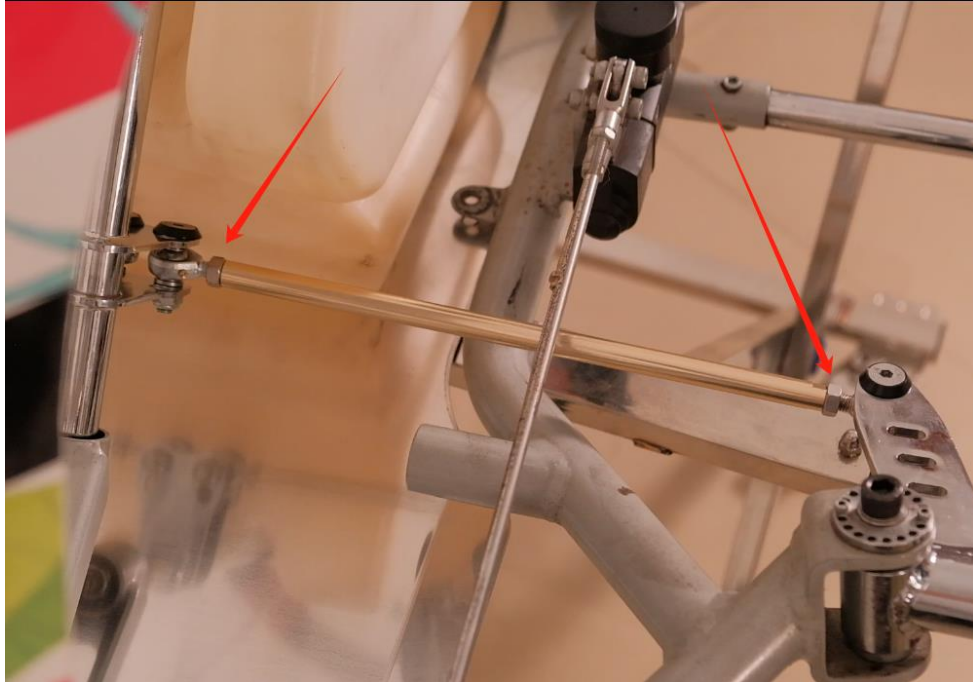

- (2) turn the opposite side connecting rod to center the toe.

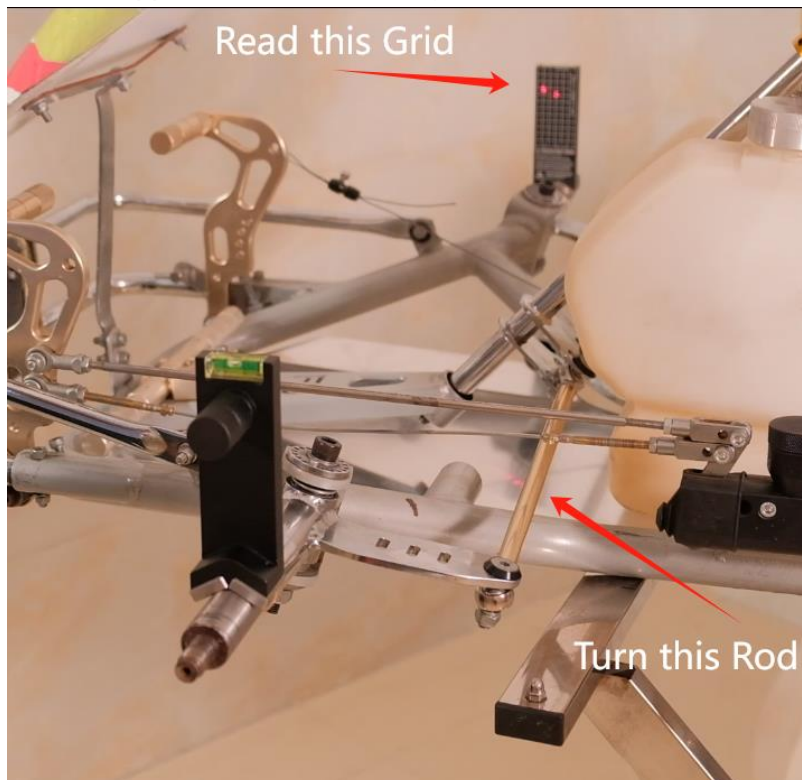



- (3) Adjust till the projected dot as desired. Middel line is neutral toe.

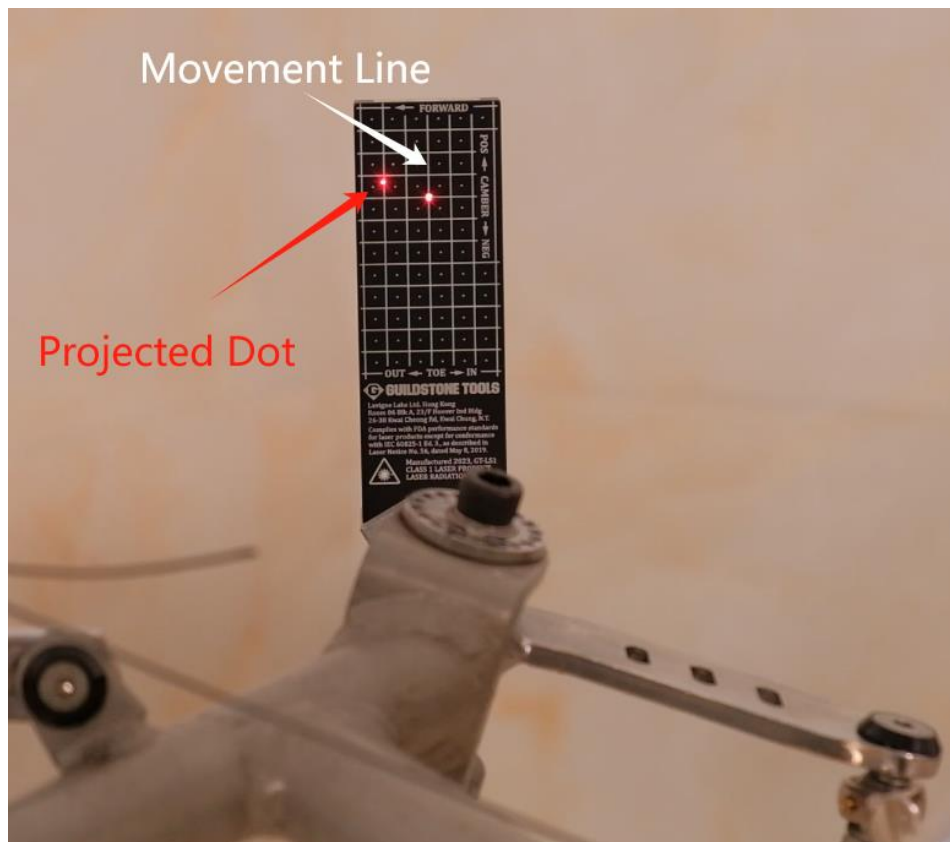

- (4) Centered Dot

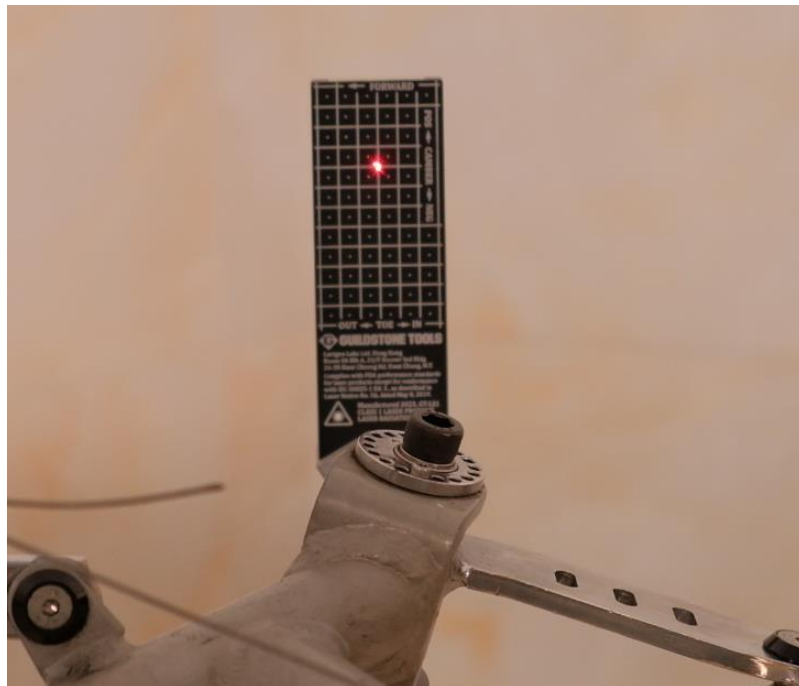

5. Adjusting camber

Camber is represented on the vertical axis on the grid, changing the camber will result in the dot moving up and down on the grid.

- (1) We have 2mm positive camber in this situation

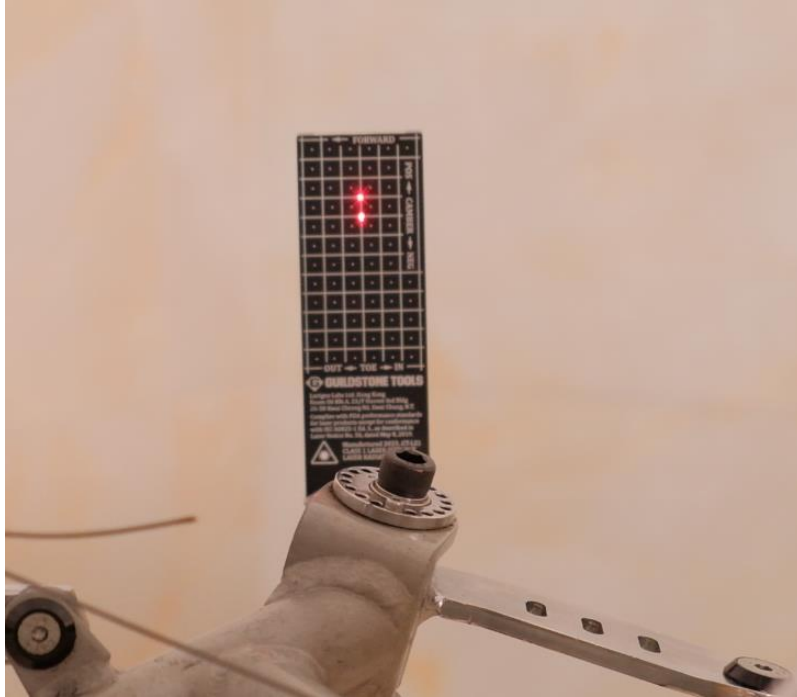

- (2) Loosen the king-pin

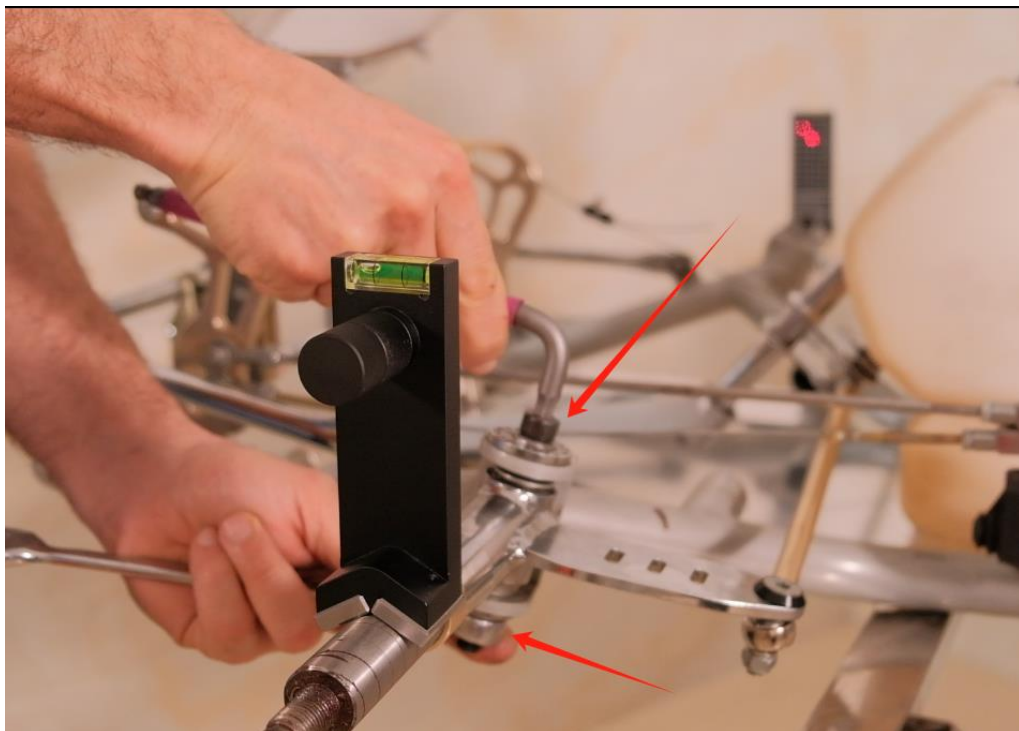

- (3) Remove the locking screw



(4) Turn the dial plate to adjust the camber to desired value

(5) Put back the locking screw and tighten the king-pin.

(6) Repeat on the second side

After adjusting camber, re-center the steering, level the lasers and take a new reading. Re-adjust as needed.

If you encounter any issues, please contact us at help@guildstone.tools.

Thanks for your support!